

Installation Instructions

The following instructions are general guidelines. Installation should be performed by a qualified electrician in accordance with the National Electrical Code and any applicable local codes. Read through the entire instructions before beginning installation. Contact Celestial Lighting for further assistance.

Option 1: Mount Module to Surface

Step 1 Start installation at the beginning of the run closest to the power supply. Install the pigtail into the first module using the male and female connector.

Mount LED module to secure surface using mounting tabs located on the fixture. #4 screws recommended.

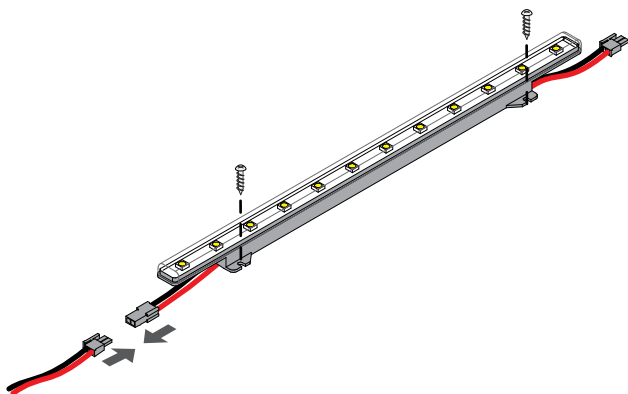

Step 2 Continue run by connecting the male and females together. Align the next fixture to the end of the first fixture.

Screw mount fixture to secure surface using appropriate screws.

Multiple groups of modules may be daisy-chained together, so long as the total length of run does not exceed 30 feet. For applications longer than 30 feet, a new run must be fed separately from the power supply.

See step 3 on how to feed.

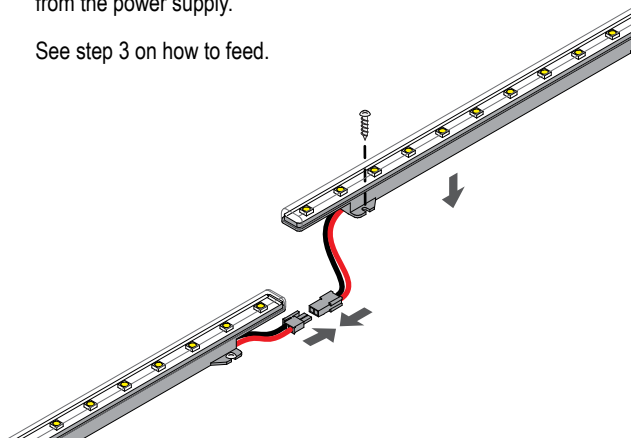

Option 2: Mount Module to channel

Step 1 Channel ships in 5 feet sections. Cut to length if needed before mounting to surface. Use appropriate screws 3 per 5 feet section recommended.

Mount channel end to end for the entire length of run. Install the pigtail into the first module using the male and female connector and snap module into mounting channel at the beginning of the run closest to the power supply.

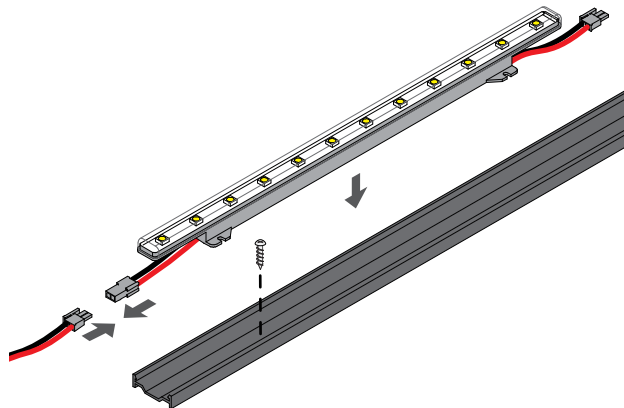

Step 2 Continue run by aligning the next fixture to the end of the first fixture. Connect male and female connectors and snap module into the channel.

Multiple groups of modules may be daisy-chained together, so long as the total length of run does not exceed 30 feet. For applications longer than 30 feet, a new run must be fed separately from the power supply.

See step 3 on how to feed.

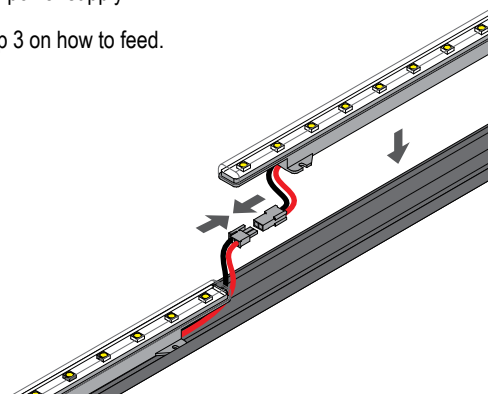

Step 3 Wire end of pigtail into power supply. The length of the pigtail wire is 36 inches in length. If the locations of the power supply is more than 36" away, attach additional wire using wire-nuts. (not included) To avoid the effects of voltage drop, see chart below to determine the recommended cable gauge wire used to feed from the power supply to the start of the lightstrip.

