

ANDROMEDA LM Series

Fixture Construction

- Surface mounted LED module in 12" length
- Module consists of LED circuit board, PVC housing and polycarbonate lens
- Mounting tabs make securing modules to surface easy
- Tabs snap into available mounting channel for quick installation of straight runs
- Male/female connectors simplify electrical connection of modules

Optical Characteristics

- 2900K LEDs emulate halogen light
- LEDs contain Cree chips
- Produces 160 lumens per foot
- LEDs spaced 1.00" on center (12 LEDs per 12" module)
- 120° wide beam angle of LED creates even illumination
- Tight color-binning of LEDs ensures uniformity of color
- Emits no UV and no IR

Electrical Specifications

- Consumes only 2.5W per foot
- Runs on 24V AC (Use with available Power Supply)
- Dimmable with most standard magnetic low voltage dimming systems
- Maximum run length is 30 feet per feed point
- ETL Listed for Dry and Damp Location
- Certified for closet light applications in accordance with NEC Code, Section 410.16

Heat Management and Rated Life

- LEDs operate on low current of 0.1 Amp per foot
- Low current generates minimal heat, preserving LED life without need for elaborate heat sink
- Rated life is 50,000 hours, with minimum 70% lumen maintenance, when used in normal environmental conditions
- Long life results in low maintenance and replacement costs
- Produces no radiant heat; optimal for heat-sensitive applications

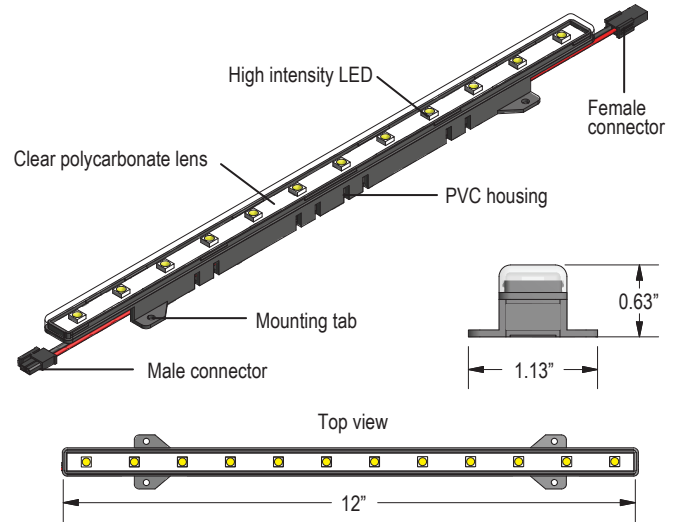

Flexible Connectors

Flexible male / female connectors allow modules to be laid out along virtually any radius or corner.

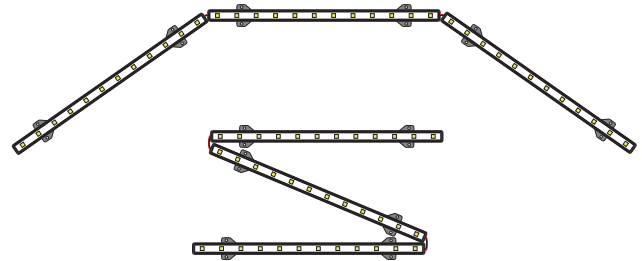

Seamless Illumination

Consistent LED spacing is maintained between modules when connected end-to-end, creating no gaps in light.

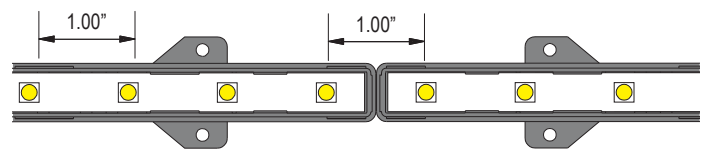

Mounting Channel (Optional)

For quick and easy installation of straight runs. Use one screw per foot to secure channel to surface, then snap in LED modules. Made of black PVC. Order in 5 ft sections; cut to length as needed.

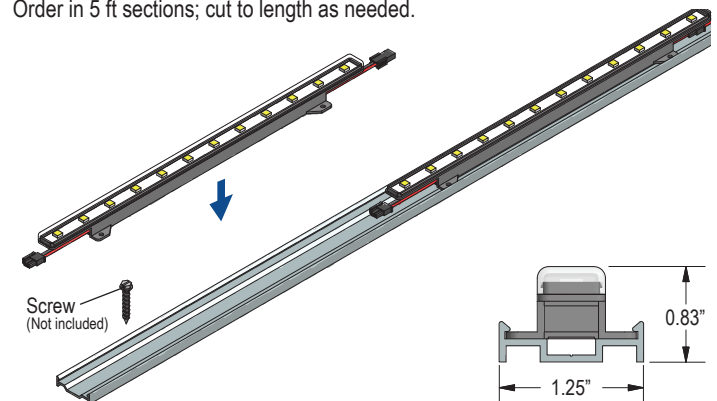

How to Specify ANDROMEDA LM Series

| Part Number | Description |
|-------------|---|
| AND-LM-W29 | Andromeda LM Series 2900K 12" module |
| AND-LM-MC | Andromeda LM Series Mounting Channel (5ft.) |

Accessories

Pigtails (Pair)
AND-LM-PT

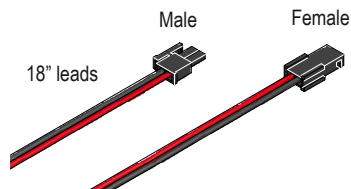

Order one pair per run. Each pair includes one male pigtail and one female pigtail. Use one, depending on which end of fixture is being fed.

Raceway
AND-LM-RW

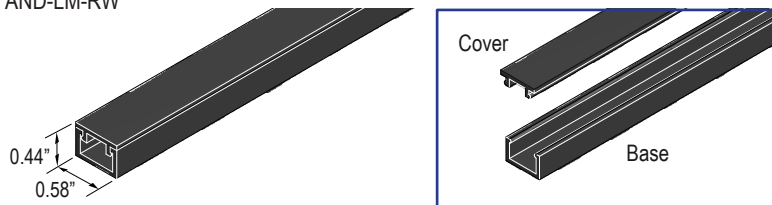

Use to enclose lead wires and splice connections. Low profile and clean shape make raceway inconspicuous and unobtrusive. Made of black PVC. Ships in 5ft sections. Cut to length and miter-cut at corners. Mount base to surface and snap in cover.

Power Supplies

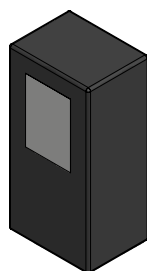

Ratings

Input: 120VAC or 277VAC 50/60Hz
Output: 24VAC
Output current: 4 Amps per output circuit
Maximum output power: 100W or 300W
Overload protection: Automatic shut-down / reset
Enclosure: NEMA 3R, with conduit knockouts
Operating temperature: -30° to 60° Celsius
Certification: ETL Listed Class 2 Power Supply
Dimming: Compatible with most standard magnetic low-voltage dimmers, wired to input side

Mount to secure surface in accessible area with adequate ventilation.
To minimize volatage drop, install power supply within 20ft of start of LED strip using 12 gauge lead wire, 40ft using 10 gauge, or 100ft using 8 gauge.

Ordering Codes

| Item Number | Watts | Volts | Outputs | Dimensions | Weight |
|-------------|-------|-----------------|---------|-----------------------------|--------|
| APS-120-100 | 100 W | 120VAC to 24VAC | 1 X 4A | 6.75" H x 6.25" W x 4.75" D | 11 lbs |
| APS-277-100 | 100 W | 277VAC to 24VAC | 1 X 4A | 6.75" H x 6.25" W x 4.75" D | 11 lbs |
| APS-120-300 | 300 W | 120VAC to 24VAC | 3 X 4A | 6.75" H x 6.25" W x 4.75" D | 12 lbs |
| APS-277-300 | 300 W | 277VAC to 24VAC | 3 X 4A | 6.75" H x 6.25" W x 4.75" D | 15 lbs |

How to Feed ANDROMEDA LM Series (Maximum 30ft per run)

100W Power Supply
Feeds up to 30ft



300W Power Supply
Feeds up to 90ft total (30ft per 100W output)

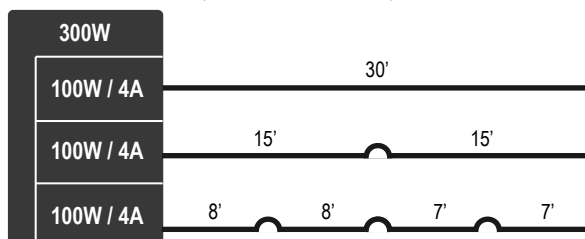

Multiple groups of modules may be daisy-chained together, so long as total length of run does not exceed 30ft.