

GEMINI 1800 Dual Step Light
Illuminates step edge and tread below with single lightstrip

Stair Nose

- Made of durable PVC
- Withstands heavy foot traffic
- Ribs help prevent slipping
- Profile is ADA compliant (No trip hazard)

Translucent Edge

- Allows LEDs from lightstrip underneath to illuminate step edge

Single Lightstrip

- Projects light above to illuminate step edge
- Also projects light onto step tread below
- Light output complies with requirements of NFPA's Life Safety Code

Lens

- Made of durable PVC
- Protects lightstrip from liquid
- Designed to minimize glare
- Snaps in and out for easy relamping

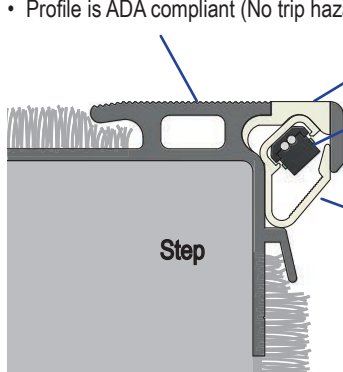

Dimensions

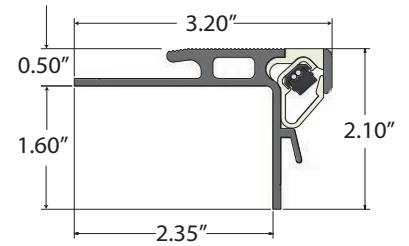

Gemini 1800 LEDs

- Safe – **12V DC power**
- Energy efficient – **Less than 0.3W per LED**
- Rated for long life – **Up to 100,000 hrs**
- Vibration resistant
- Individually replaceable
- Dimmable with most low voltage magnetic dimmers

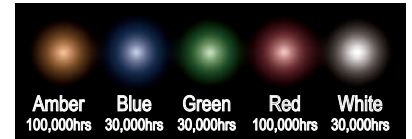

GEMINI 1800 System

Wire Harness

- 14 gauge wires feed power to each step light

Raceway Base

Bare Floor

End cap (left shown)

- Finishes corner where step light meets raceway, providing seamless appearance with matching ribs and contours
- Secured to tread surface, preventing displacement
- Made of durable PVC

Raceway Cover

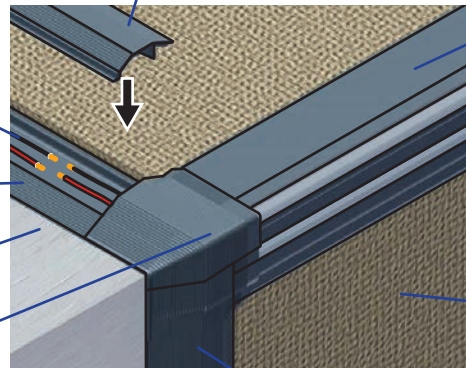

GEMINI 1800 Step Light

Carpeted Step

Raceway

- Protects wires feeding each step light
- Provides transition from carpeted step to bare floor
- Removable cover enables easy access to wiring
- Made of durable PVC

Use with Celestial 12VDC transformer.
(See Power Supply specifications)
Warranty void if used with other power supplies.

How to Specify GEMINI 1800 Series

GEM - 1800 -		-	
	LED Color		LED Spacing
	A	Amber	4 4" on center
	B	Blue	6 6" on center
	G	Green	
	R	Red	
	W	White	
Example			Consult factory for custom spacings
GEM - 1800 -	A	-	6

Raceway
GEM-5SR

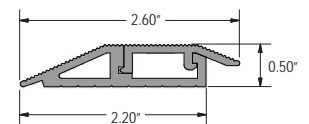

Left End Cap
GEM-CPL



Right End Cap
GEM-CPR

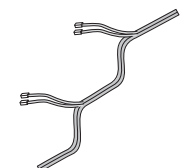

Wire Harness
GEM-WH

Power Supplies

Ratings

- Input: 120VAC or 277VAC, 50/60 Hz
- Output: 12VDC
- Output current: 5 Amps per output circuit
- Maximum output power: 60W or 240W
- Overload protection: Manual reset circuit breaker
- Enclosure: Indoor / outdoor enclosure with conduit knockouts
- Operating temperature: -30° to 60° Celsius
- Certification: UL Class 2 Power Supply

Maximum Load

- Maximum 150 LED modules per 5A output circuit
- Do not connect more than 150 LED modules per 5A output

Dimming

- Compatible with most standard magnetic low voltage dimmers
- Wire dimmer to primary side of power supply
- Requires minimum 50 LED modules per 5A output for effective dimming
- Recommended dimmer: Lutron Nova Series NTLV-600 (120VAC, 600W, single pole)

Ordering Codes

Item Number	Watts	Volts	Outputs	Dimensions	Weight
GPS-120-60	60 W	120VAC to 12VDC	1 X 5A	11.25" H x 3.375" W x 3.25" D	7 lbs
GPS-277-60	60 W	277VAC to 12VDC	1 X 5A	11.25" H x 3.375" W x 3.25" D	7 lbs
GPS-120-240	240 W	120VAC to 12VDC	4 X 5A	14.25" H x 8.750" W x 4.50" D	20 lbs
GPS-277-240	240 W	277VAC to 12VDC	4 X 5A	14.25" H x 8.750" W x 4.50" D	20 lbs

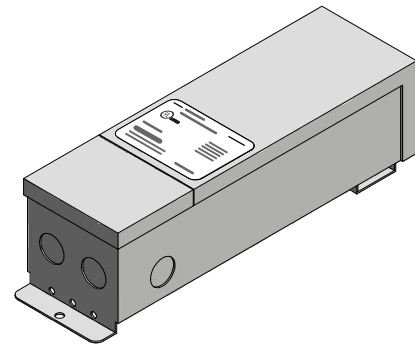

Must be mounted in an accessible location with sufficient ventilation and must not be submerged.

How to Feed GEMINI 1800 (Maximum 150 LEDs per 60W/5A output)

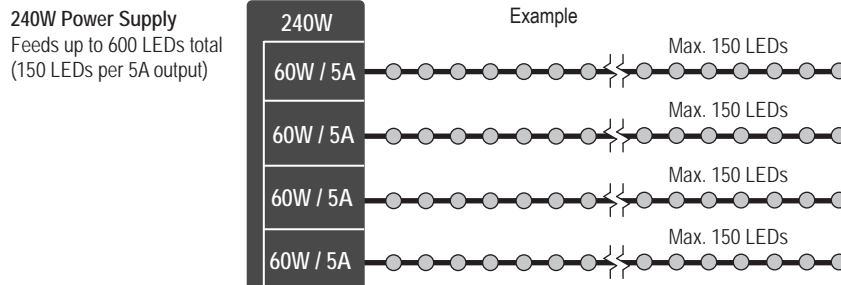
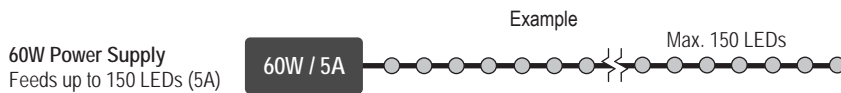

GEMINI 1800 lightstrip uses 18 gauge red/black cable for 12VDC. (Polarity: Red - positive, Black - negative)