

**Installation Instructions**

The following instructions are general guidelines. Installation should be performed by a qualified electrician in accordance with the National Electrical Code and any applicable local codes. Read through the entire instructions before beginning installation. Contact Celestial Lighting for further assistance.

**Step 1** Start the run by placing the fixture closest to the power supply with the male connector at the start of the run. Mount Striplight to secure surface using mounting tabs located on the fixture. Appropriate screws must be used depending on the surface being mounted.

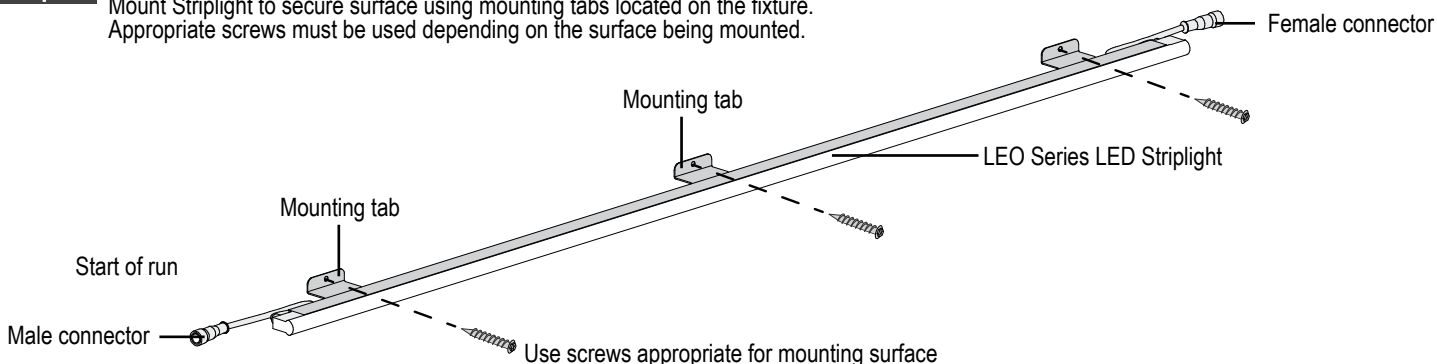

**Step 2** Continue run by aligning the next fixture to the end of the first fixture leaving a 1/4" gap. Make sure that the male connector on the next fixture is facing the female connector on the first fixture. Screw mount fixture to secure surface using appropriate screws. Multiple combinations of nominal 5 feet and 1 feet fixtures may be connected together, so long as the total length of run does not exceed the maximum run chart below. For applications longer than the maximum run, a new run must be feed separately from the power supply.

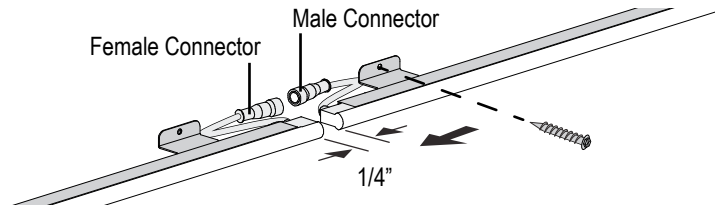

| LED Color   | Max.Run |
|-------------|---------|
| White (all) | 20 ft   |
| Blue        | 20 ft   |
| Green       | 20 ft   |
| Orange      | 20 ft   |
| Yellow      | 30 ft   |
| Red         | 30 ft   |

The LEO series striplight can be installed around corners shown below.

**Outside corner**

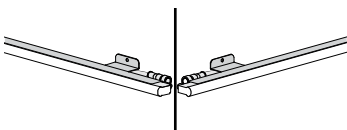

**Inside corner**

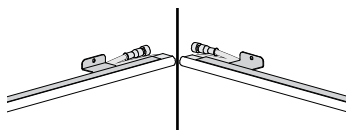

**Frontal corner**

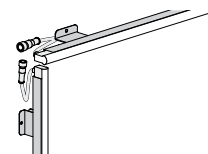

**Step 3** Connect male and female connectors. Make sure to screw female connector to male connector tightly to prevent water from getting into the connectors. Tuck wires underneath the mounting bracket. Attach end cap connector to the end of run.

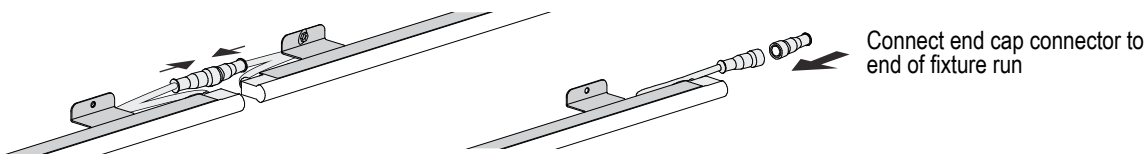

**Step 4** Connect pigtail to beginning of run. Make sure male and female connectors are tightly screwed together.

Wire end of pigtail into power supply. The length of the pigtail is 36 inches in length. If the locations of the power supply is more than 36 inches away, attach additional wire using wet location connectors (not included). Outdoor rated cables and connectors must be used for outdoor applications.

To avoid the effects of voltage drop, see chart below to determine the recommended cable gauge wire to use to feed from the power supply to the start of the lightstrip.

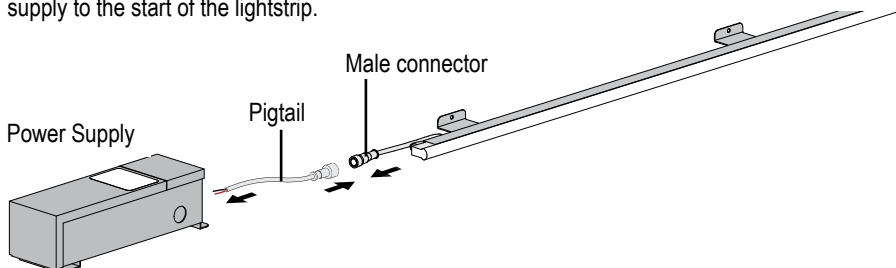

| Wire gauge | Max. feed run |
|------------|---------------|
| 14 AWG     | 40 ft.        |
| 12 AWG     | 60 ft.        |
| 10 AWG     | 100 ft.       |