

**Installation Instructions**

The following instructions are general guidelines. Installation should be performed by a qualified electrician in accordance with the National Electrical Code and any applicable local codes. Read through the entire instructions before beginning installation. Contact Celestial Lighting for further assistance.

**Step 1** The lightstrip ships in rolls of 20 feet. Each 20ft lightstrip includes pre-attached lead wires, 6 inches long. The end of the lead wire must be connected to the power supply using wet location connectors (Wire-nuts/connectors and feed wires provided by contractor).

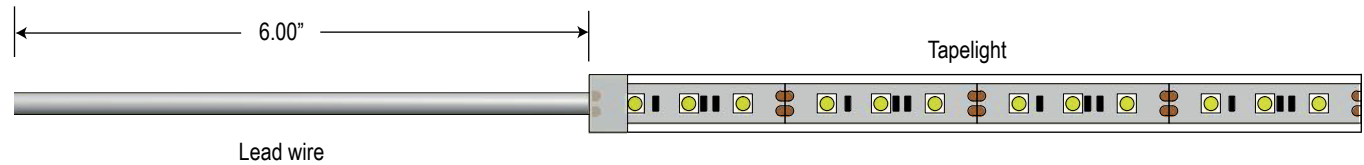

**Step 2** 20 feet is also the maximum run length for this lightstrip. Do not daisy-chain 20ft sections together. For applications longer than 20 feet, each 20 foot lightstrip must be fed separately from the power supply.

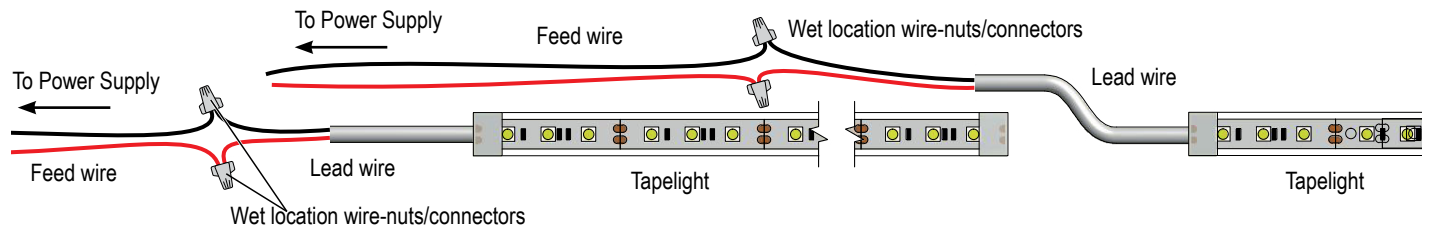

**(Wire-nuts/connectors and feed wires provided by contractor)**

**Step 3** For applications shorter than 20 feet, the lightstrip may be field-cut, in increments of approximately 4 inches (every 6 LEDs). Apply silicone or other sealant to the cut end. Do not attempt to attach connector to cut-off loose pieces of tapelight. Consult factory for custom cut lengths.

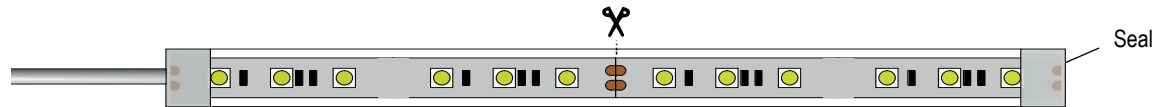

**Step 4** Remove protective film on the back of the LED tape light and apply the double sided stick tape directly onto smooth surface. (Use double sided stick tape only on smooth surfaces) Use mounting clips to mount lightstrip to surface. (Use screw appropriate for mounting surface.) At least one clip recommended per foot. Make sure to position clip in between LEDs.

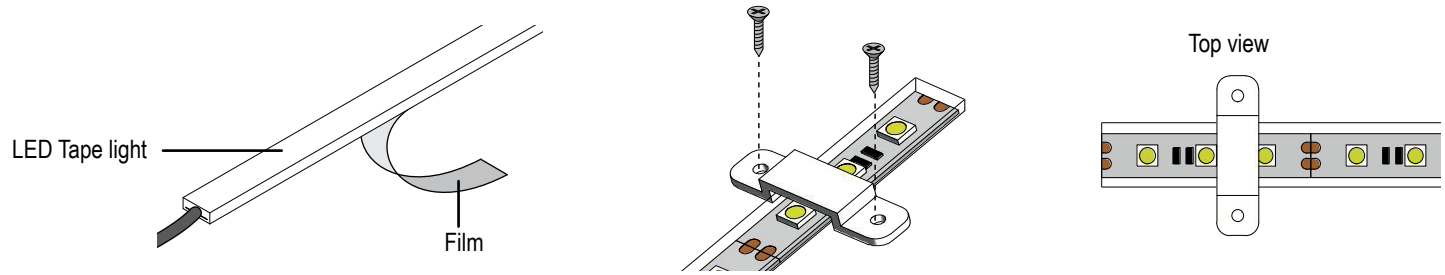

**Step 5** This lightstrip runs on 24V DC. Make sure the power supply output is 24V DC. Each 20ft length consumes 86 Watts (4.3W per foot). When feeding the lightstrip, do not exceed the wattage rating of the power supply per circuit. To avoid the effects of voltage drop, see chart below to determine what cable gauge wire is required depending on how far the power supply is located from the start of the lightstrip. For outdoor applications, outdoor rated cables must be used.

Maximum run length 20ft (86W) per 100W output

