

HYDRA LS Series

Features

- Wet location light string with replaceable miniature incandescent lamps
- Ideal for linear accent lighting to outline building exteriors or for lighting trees and shrubs
- Not rated for submerged applications; do not mount in manner or application with potential of lightstrip being submerged. eg) standing water, snow

Fixture Construction

- Cable consists of 18-gauge stranded copper conductors and PVC insulation rated for outdoor
- Durable polycarbonate lampholder is permanently secured to cable
- Miniature incandescent lamp is individually replaceable
- Clear cap protects lamp
- Standard 6" lamp spacing (Consult factory for custom spacings)
- Optional mounting clips

Optical Characteristics

- Available in 1850K and 2150K incandescent
- Unique design allows light to be visible from all sides

Electrical Specifications

- Lamp consumes only 0.33W and 0.88W each
- Runs on 24V AC
- Use with available UL Class 2 Power Supply
- Operating temperature is -20°C to 40°C
- Use with available UL Class 2 power supply (See power supply specifications)

Heat Management and Rated Life

- Lamps operate on low current of 0.013 Amp each for 1B lamp
- Lamps operate on low current of 0.04 Amp each for 2B lamp
- Rated life is 30,000 hours, when used in normal environmental conditions
- Long life results in low maintenance and replacement costs

Maximum Run Chart

Lamp Type	Watts	Max Run (6" oc lamp spacing)
1B - 1850K	0.33	100 ft
2B - 2150K	0.88	45 ft

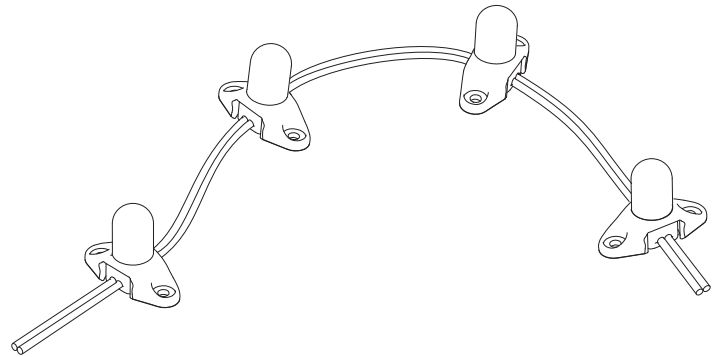

Shown with optional mounting clip

Shown without mounting clip

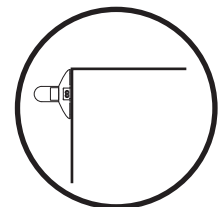
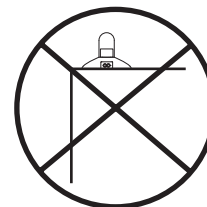
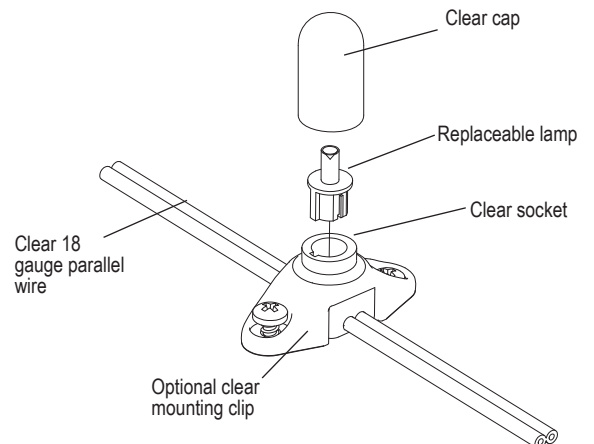
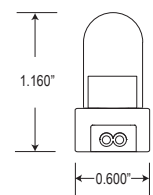
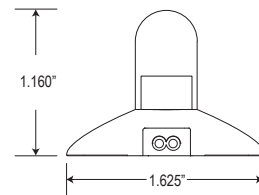

How to Specify HYDRA LS Series

HYA - LS - - -

Lamp	
1B	1850K incandescent lamp (100ft max run)
2B	2150K incandescent lamp (45ft max run)

Lamp Spacing	
6	6" on center

Mounting	
LO	No mounting clip
MC	Mounting clip

Example

HYA - LS - - -

Power Supplies

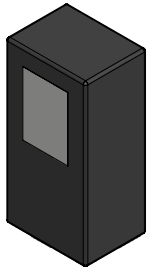

Ratings

Input: 120VAC or 277VAC 50/60Hz
 Output: 24VAC
 Output current: 4 Amps per output circuit
 Maximum output power: 100W or 300W
 Overload protection: Automatic shut-down / reset
 Enclosure: NEMA 3R, with conduit knockouts
 Operating temperature: -30° to 60° Celsius
 Certification: ETL Listed Class 2 Power Supply
 Dimming: Compatible with most standard magnetic low-voltage dimmers, wired to input side

Mount to secure surface in accessible area with adequate ventilation.
 To minimize volatage drop, install power supply within 20ft of start of first lamp using 12 gauge lead wire, 40ft using 10 gauge, or 100ft using 8 gauge.

Maximum Run

Maximum 90 lamps per 4A output circuit (45ft at 6" lamp spacing)
 Do not connect more than 90 lamps per 4A circuit

Ordering Codes

Item Number	Watts	Volts	Outputs	Dimensions	Weight
APS-120-100	100 W	120VAC to 24VAC	1 X 4A	6.75" H x 6.25" W x 4.75" D	11 lbs
APS-277-100	100 W	277VAC to 24VAC	1 X 4A	6.75" H x 6.25" W x 4.75" D	11 lbs
APS-120-300	300 W	120VAC to 24VAC	3 X 4A	6.75" H x 6.25" W x 4.75" D	12 lbs
APS-277-300	300 W	277VAC to 24VAC	3 X 4A	6.75" H x 6.25" W x 4.75" D	15 lbs

How to Feed HYDRA-LS Series

1B - 1850K Incandescent Lamp

100W Power Supply
 Feeds up to 100ft



300W Power Supply
 Feeds up to 300ft total (100ft per 100W output)

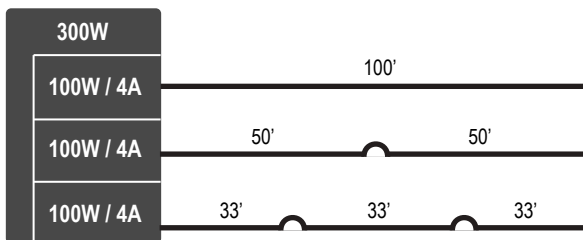

Multiple strips may be daisy-chained together, so long as total length of run does not exceed 100ft.

2B - 2150K Incandescent Lamp

100W Power Supply
 Feeds up to 45ft



300W Power Supply
 Feeds up to 135ft total (45ft per 100W output)

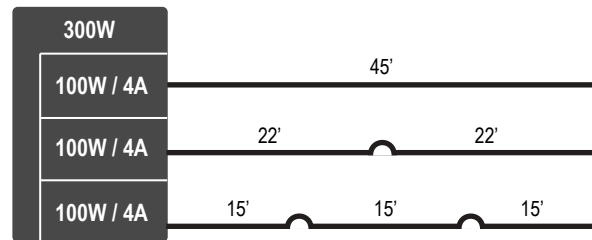

Multiple strips may be daisy-chained together, so long as total length of run does not exceed 45ft.